

Sony Electronics Inc.  
Business and Professional Products Group  
Technical Publications  
3300 Zanker Road, San Jose, California 95134

### Display

Date: **September 26, 1994**

Subject: **PART REGISTRATION—BOTTOM  
PLATE ASSEMBLY**

Model: **BVM-1910/1911/1912/1915/1916**

Serial No: **ALL**

### DESCRIPTION

The bottom plate assembly is now registered as service part number **X-4379-410-6**. Accordingly, update the following manuals as shown in Figure 1:

- BVM-1910 Operation and Maintenance Manual
- BVM-1912 Operation and Maintenance Manual
- BVM-1915, BVM-2015P/PM Operation and Maintenance Manual

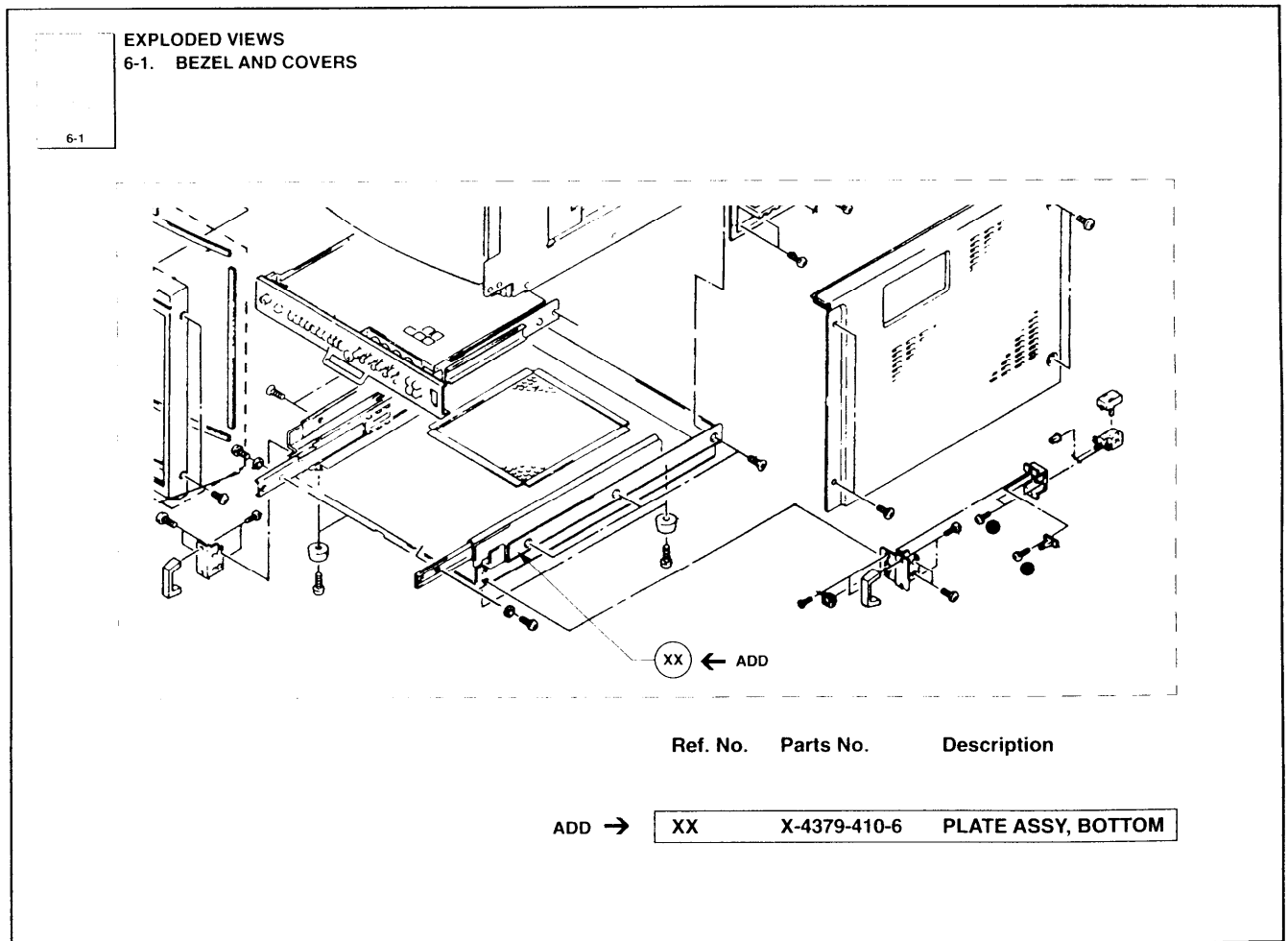

**Figure 1**